

# MEASURE- and BLEEDER-CONNECTIONS

## Series MA 7250 PSI

Sheet No.  
**1650 D**

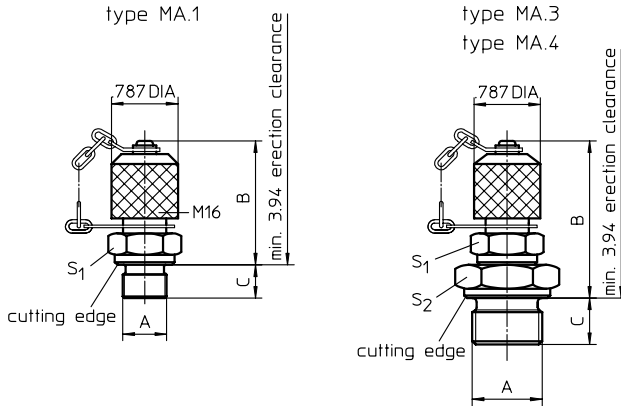

sealing material: viton (FPM)

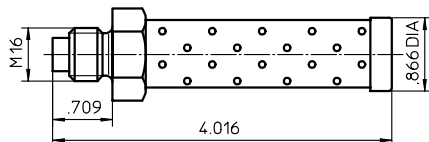
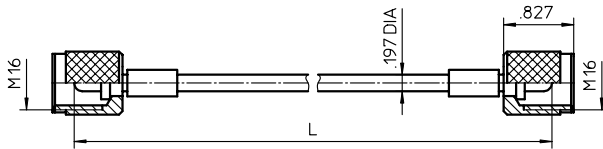
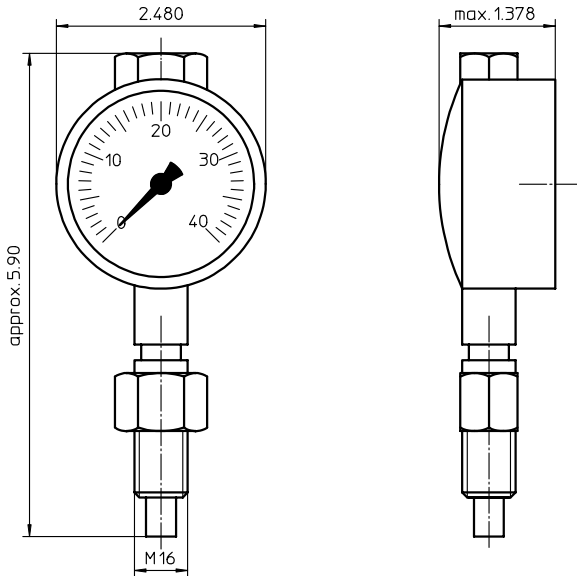

### Mini-measuring connection

#### 1. Type index: (ordering example)

##### MA. 1. ST

1	2	3
---	---	---

- 1 **series:**  
MA = mini-measuring connection
- 2 **screwed plug:**  
1 = 1/4 BSPP  
3 = 1/2 BSPP  
4 = 3/4 BSPP
- 3 **material:**  
ST = steel  
VA = stainless steel

#### 2. Dimensions:

type	A	B	C	S <sub>1</sub>	S <sub>2</sub>
MA.1	1/4 BSPP	1.42	.04	.75	-
MA.3	1/2 BSPP	1.80	.55	.75	1.06
MA.4	3/4 BSPP	1.80	.63	.75	1.26

### Pressure gauge

#### 1. Type index: (ordering example)

##### Pressure gauge. 16

1	2
---	---

- 1 **series:**  
pressure gauge
- 2 **pressure range:**  
16 = 0 - 232 PSI  
40 = 0 - 580 PSI  
100 = 0 - 1450 PSI  
250 = 0 - 3625 PSI  
600 = 0 - 8700 PSI

### High pressure hose

#### 1. Type index: (ordering example)

##### High pressure hose. M 16. 630

1	2	3
---	---	---

- 1 **series:**  
high pressure hose
- 2 **threaded connection:** M 16
- 3 **length:**  
630 = 25 inch  
2000 = 79 inch

### Spray protection M 16

(ordering example)

Changes of measures and design are subject to alteration!

EDV 07/99

## **Description:**

The measuring-connection and spray protection are designed for filters up to PN 7250 PSI. The measuring-connection has to be mounted tightly to the foreseen measure connection- and spray protection spots.

It is possible to connect the pressure gauge by means of high-pressure hose with the screw coupling M16 without interrupting operation.

The high-pressure hose is to be deaerated before the first measuring.

A capillary effect prevents a drain off of the operating fluid.

The spray protection must be used in connection with the high-pressure hose and is designed for filters with a capacity of approx. 2.65 GPM.

## **Note!**

The deaeration is only to be executed with operating pressure up to max. 464 PSI. A flow of approx. .32 GPM of operating fluid is given at a pressure of 464 PSI and a viscosity of 125 SUS. It is inadmissible to connect the high-pressure hose with the measuring-connection without spray protection respectively without connected pressure gauge. (risk of injury)